

XXYRON[®]PRO 1200

USER'S GUIDE

Adhesive Application & Laminating System



The XM1200 is an economical and easy to use document finishing system. This versatile and non-electric system has been designed to laminate or apply mounting adhesive to a variety of media. The same system is capable of laminating, selectively applying adhesive or applying laminate and adhesive at the same time. With the XM1200, documents are easily laminated or can be transformed into signs, stickers or labels instantly. The machine and supplies are compatible with all types of computer-printed media including laser, inkjet, color and thermal in a wide range of material sizes and thickness.

FEATURES & FUNCTIONS

Input Side

Replaceable Supply Cartridge

Holds various lengths and combinations of film and adhesive depending upon application.

Document Feed Paddle

Helps ensure wrinkle-free output by providing slight back-tension on document.

Document Feed Tray

Used to guide document into dispenser. Leading edge of document slides in between tray and paddle during insertion. Align to right for A3/A4 documents, to the left for letter documents.

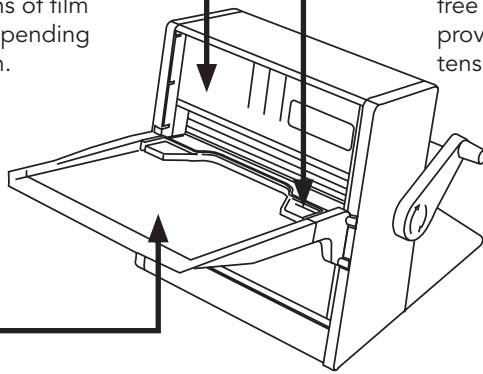

Output Side

Crank Handle

Used to advance cartridge supplies and document when rotated clockwise.

Document Output

Location where document exits the dispenser when handle is rotated clockwise.

Roller Springs

Provides spring force on rollers. Remove springs to remove rollers and cut blade.

Cut Blade

Slide to the left and right to cut output material after it exits dispenser. Also can be used to trim excess material from leading edge of document.

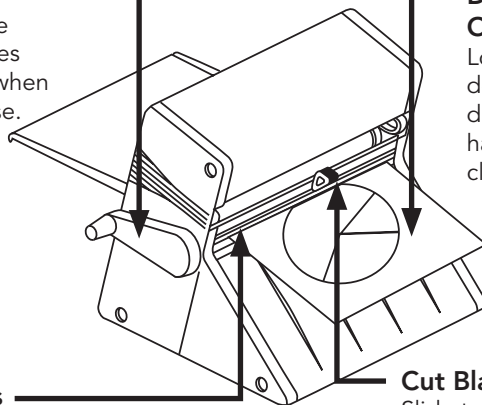

ASSEMBLY INSTRUCTIONS

Remove the Xyron System and Document Feed Tray from the packaging. The system is shipped with a sample supply cartridge already installed. Install the feed tray by inserting it horizontally into the cartridge opening by the grooves in the left and right dispenser side plates as shown. When correctly installed, the tray will rest horizontally.

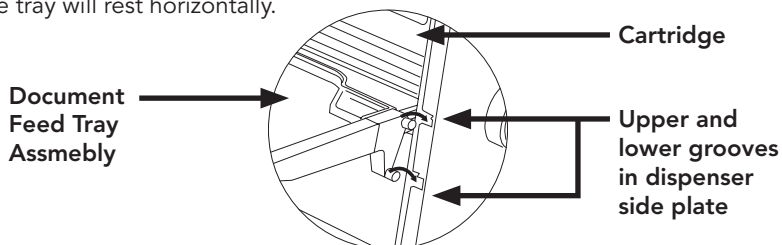

BASIC OPERATION

Step 1:

Insert and align document on feed tray. Extend the document completely into the cartridge opening. Align to the left for letter size documents, to the right for A3/A4 documents.

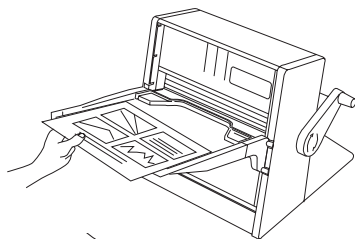

Step 2:

Gently guide the document forward while turning the handle clockwise.

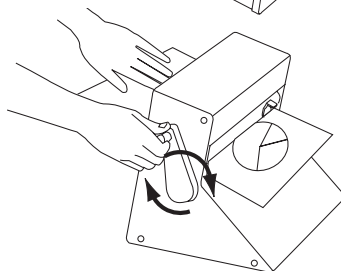

Step 3:

Trim to desired length using the cut blade at the roller exit. Apply pressure down on the orange blade holder and slide to the right or left.

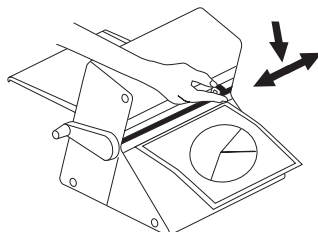

How to remove document from adhesive

- Remove the protective clear mask layer and discard.
- Always remove the liner from the media as shown.

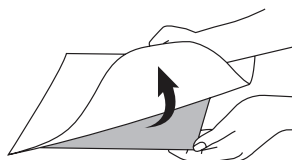

CARTRIDGE REPLACEMENT

Remove feed tray by lifting upward and gently pulling away from dispenser.

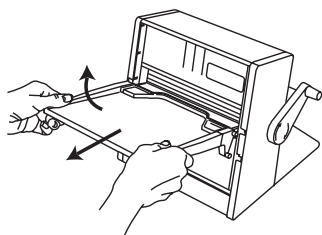

Remove used supply cartridge by pulling outward. If there is film between the rollers, turn handle counter-clockwise.

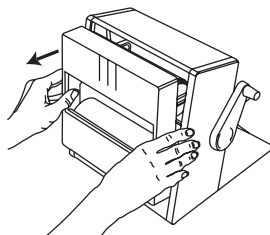

To Install New Cartridges

Position cartridge leader between the rubber rollers in dispenser.

Turn handle clockwise to advance film.

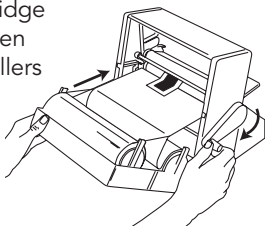

Insert new supply cartridge.

Continue to turn handle until film is aligned and wrinkle-free.

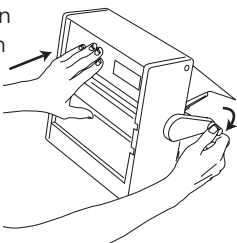

Install feed tray and trim off excess film using cut blade.

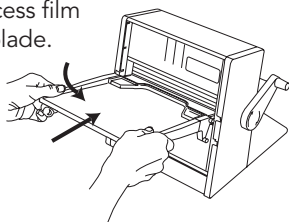

To Install Part-Used Cartridges

Attach reusable cartridge starter tool to partially used supply cartridge.

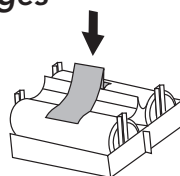

Insert partially used supply cartridge into dispenser.

Note: Tool should be positioned between rubber rollers in dispenser.

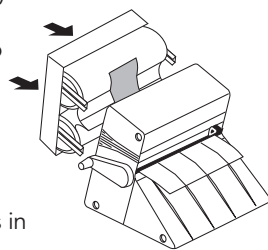

Turn handle clockwise until tool has exited dispenser and film is aligned and wrinkle-free. Store reusable starter tool for later use.

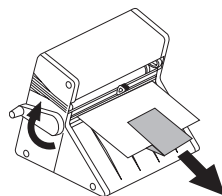

Install feed tray and trim off excess film using cut blade.

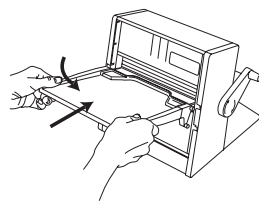

AVAILABLE SUPPLY CARTRIDGES

Product Supply Description

Permanent High-Tack Adhesive: Extremely aggressive adhesive instantly creates a permanent bond on most surfaces. Sets instantly and will not peel. Acid-Free.

Permanent Standard Adhesive: Moderately aggressive adhesive creates a permanent bond on most surfaces. Can be touched to surface, peeled back quickly, and replaced. Acid-Free.

Repositionable Adhesive: Allows items to be repositioned over and over. Easy removal from glass, walls, paper, and most other surfaces. Acid-Free.

Standard Use Laminate: High gloss film suitable for use on a variety of substrates. Superior adhesion. Compatible with most media. Acid-Free.

Combination-Laminate/Adhesive: One of the laminate products described on the top surface and one of the Acid-Free adhesives described on the bottom surface. Acid-Free.

Part Number	Product Description	Material Length	Material Width
-------------	---------------------	-----------------	----------------

Adhesive Application Cartridges

AT1101-50	Permanent High-Tack Adhesive	50' (15.25m)	12" (30.5cm)
AT1105-50	Permanent Standard Adhesive	50' (15.25m)	12" (30.5cm)
AT1106-50	Repositionable Adhesive	50' (15.25m)	12" (30.5cm)

Lamination Cartridges

DL1101-100	2-Sided Standard Use Laminate	100' (30.5m)	12" (30.5cm)
------------	-------------------------------	-----------------	-----------------

Combination One Side Laminate / One Side Adhesive Application Cartridges

LAT1101-50	Standard Use Laminate/ High-Tack Adhesive	50' (15.25m)	12" (30.5cm)
------------	--	-----------------	-----------------

TROUBLESHOOTING

Symptom	Cause	Solution
Cut blade does not cut smoothly.	Adhesive build up on cutting mechanism.	Use caution and follow cleaning procedure listed below.
Film does not exit dispenser between upper and lower blade bars.	Material is curled or adhesive has been transferred to the nip roller causing the film to stick.	Remove material and clean adhesive from rollers if necessary. Reposition material between blade bars.
Film wrinkles don't go away as crank is turned clockwise.	Adhesive build-up on rollers.	Apply adhesive cleaner to remove build-up on rollers.
Material will not advance when crank handle is turned.	Material is not positioned between rollers or laminate is adhered to input tray.	Reinstall cartridge. Slide input tray outward to release film and turn handle to assure laminate is wrinkle-free. Slide input tray back into machine.
Document wrinkles or exits machine crooked.	Adhesive build-up on front edge of input tray.	Remove adhesive from front edge of input tray.
Document peels from mounting surface at opposite corners.	Improper peel technique introduces curl in document.	Use the proper peel technique of peeling the liner from the document as shown on the previous page.

How to Maintain your Cut System

Using the finger tab of the cut bar spring, pull in and carefully remove the cut bar assembly from the machine (be cautious of exposed blade). Using caution, apply adhesive cleaner to all surfaces of bar blade. Once adhesive build-up is removed, return the cut bar assembly to the machine, guiding the location pins into the holes in the side plates.

Warranty Information

Xyron, Inc. warrants that the XM1200 is free from defects in material and workmanship for a period of one (1) year from the date of purchase. Xyron, Inc. will repair or replace a defective product or part without charge, with proof of purchase. If the product is damaged by neglect or misuse, the warranty is null and void.

To register your product online, please go to www.xyronpro.com and click on the product registration tab.

*If you purchased this product outside the United States Xyron will warrant this product in accordance with the purchasing country's laws.**

**Excludes Australia

Customer Service

We want you to be happy with your purchase of a Xyron product. If for any reason you have a problem or a question, please contact Xyron Customer Service toll-free at 1-800-793-3523 or 1-480-443-9419 for help. You can also e-mail us at: customerservice@xyron.com

For customer service outside of the U.S.

Australia: 61 2 8899 8500; australiacustomers@esselte.com

New Zealand: 64 9 272 1600; nzcustomers@esselte.com

Europe: 44 845 67801801

Asia: 813 5719 6450

6475_RevA

©2013 Xyron, Inc.
8465 N. 90th St. Suite 6
Pima Center
Scottsdale, AZ 85258

Visit www.xyronpro.com for more information

 **XYRON®**

An  **Esselte®** Company