

USER MANUAL



XXYRON®
Personal Cutting System™



BEFORE YOU BEGIN

Read these instructions carefully.

If you are missing parts or the product does not function properly, **DO NOT return this product to the store that you purchased it from.** Immediately Contact Xyron toll-free by dialing **1-877-392-9474.**

FOR YOUR SAFETY

Read and observe all cautions and warnings shown throughout these instructions.

No assembly required

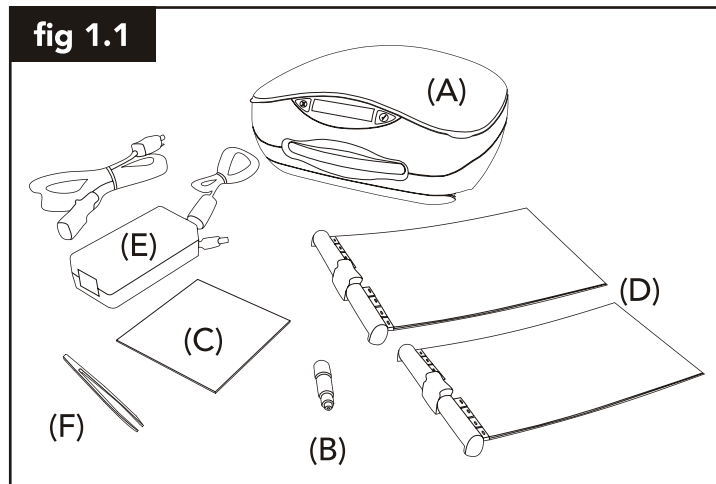

Table of Contents

System Contents

Preparing to use your Personal Cutting System™

Installing the Cutting Blade

Loading Paper

Inserting Design Books

Replacing the Cutting Mat

Selecting Shapes or Designs to Cut

Resizing Shapes

Deleting Selected Shapes

General Maintenance

Technical Specs

Trouble Shooting Guide

System Contents:

(A) Cutting Machine

(B) Cutting Blade

(C) Cutting Mat

(D) Two Design Books

(E) Power Cable

(F) Shape Removal Tool

***Preparing to use your
Xyron Personal Cutting System™***

1. Carefully unpack all components – retain all packaging for future storage or transportation
2. Compare contents to the parts list (fig 1.1). If any parts are missing, **DO NOT return to the location that you purchased the Personal Cutting System™**. Call Xyron, toll-free, **1-877-394-9474** for immediate assistance.
3. Place your Xyron on a flat, stable surface close to an electrical outlet.

WARNING: Do not use this product around water or other electrical hazards.

Installing the Cutting Blade

WARNING:

1. **Make sure the Personal Cutting System™ is off, and unplugged from electrical outlet.**
2. Open the top lid on the top of the Personal Cutting System™.
3. Carefully remove the blade from the package and insert into Tool Holder as shown in fig 2.1.
4. Tighten the side-screw by turning clockwise. Tighten with fingers until snug.
5. If discarding a used or dull blade, place the used blade into the package of the new replacement blade, and discard entire package.

fig 2.1

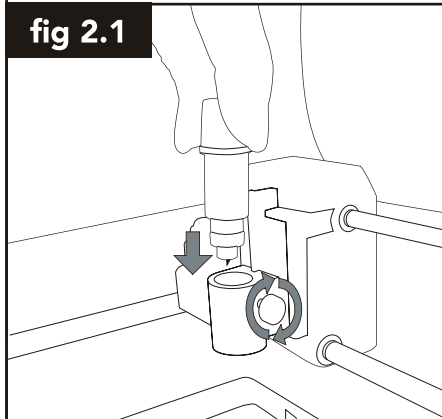

CAUTION!

Do not overtighten as you could damage the tool holder.

Loading Paper

1. Pull out the paper/cutting tray by depressing the button on the front of the tray, and pulling away from the machine (fig 3.1). The paper/cutting tray will eject entirely from the machine.

fig 3.1

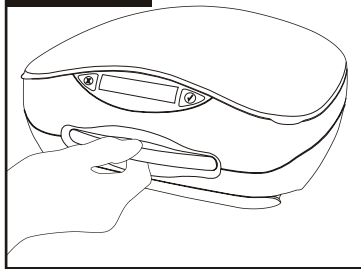

2. Notice of how the sample paper is positioned in the upper left corner on the paper tray. This is the proper position of paper that you intend to cut. Remove the sample paper and discard.

fig 3.2

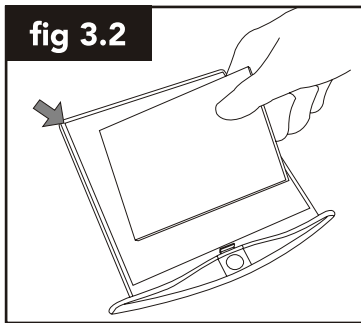

3. Trim paper that you intend to cut to 4"x 4".
4. Position paper on the tray and align to the upper left hand corner. (fig 3.2)

 **TIPS** _____

1. Open the top lid if you need to manually clear material of the cutting surface, or to clean the machine.
2. The top lid is designed to snap off the machine if too much force is applied to during handling. The top lid simply snaps into place at the back hinge to the machine. No tools are required.

Paper/Cutting Tray

 **TIPS** _____

1. To remove the tray , press the button on the tray lip and pull out of the machine.
2. Inserting the tray. The tray will lock the tray into place for cutting.

Inserting Xyron Design Books

2. Remove Xyron Design Book from the protective packaging.
3. Keep the book closed and insert the spine of the Design Book into the center of the dock (fig 4.2). Be sure that the entire spine sits firmly into the dock. If the book does not easily fit into place, the book may be upside down. If upside down, remove, rotate and reinsert.
4. When a Design Book is properly loaded, it will appear as shown in fig 4.3.
5. After proper insertion, open the book to select shapes.

fig 4.2

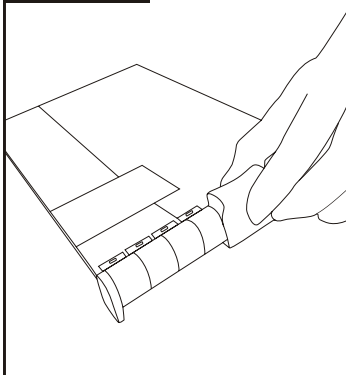
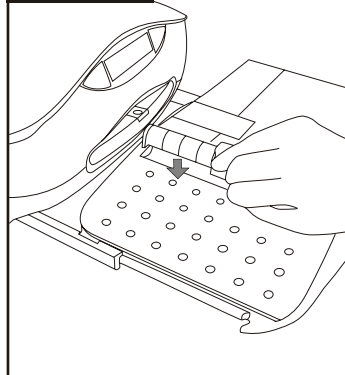
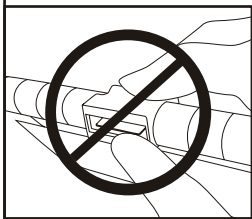
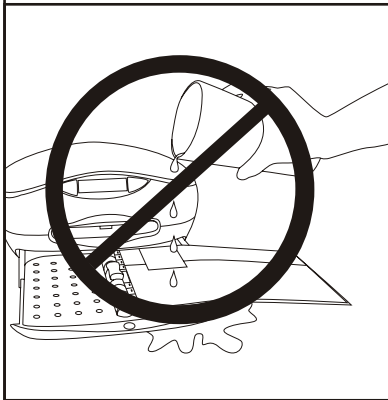

fig 4.3



WARNING:

Do not spill liquids onto the dock. Damage and risk of shock could occur. Exposing the dock to excessive moisture, such as outdoor use, could cause safety and mechanical hazards.



CAUTION!

Do not intentionally touch the electronic connections located on the spine of the book. Dirt and oils can shorten the life of the Design Book.



CAUTION!

Do not transport your Personal Cutting System™ with the dock extended.

WARNING

HAZARDOUS MOVING PARTS
KEEP FINGERS AND OTHER BODY
PARTS AWAY

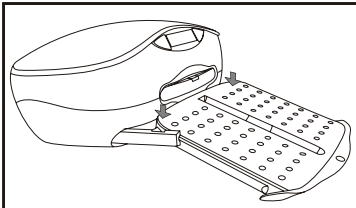

CAUTION!

Do not use the Personal Cutting System™ with the dock overhanging a table. This will cause the dock to break-away.

✓ TIPS

1. Ensure good connection between dock and design books by applying firm pressure to the spine when inserting into the Personal Cutting System™.
2. When the machine is on, and a book is inserted correctly, the name of the book will appear on the LCD screen.
3. The dock **WILL NOT** close when a design book is inserted. To remove a book, simply grab the middle of the spine and pull up.
4. Store books in a dry, dust-free location.
5. Do not transport your Personal Cutting System™ with the dock extended and do not attempt to carry your Personal Cutting System™ by the dock.

Replacing the Cutting Mat

The cutting mat is a self healing, tacky material that keeps paper in place during the cutting process. Over time, paper, dust, and dirt will cause the cutting mat to have a reduced tacky feel. When paper no longer is held in place throughout an entire cut (the blade pushes the paper around), a new mat is required. Avoid touching tacky, surface by using the shape removal tool.

1. Remove the paper/cutting tray by depressing the button on the tray, and remove completely from the Personal Cutting System™.
2. To remove the mat grasp a corner of the used cutting mat, remove completely and discard.
3. Unwrap a new Personal Cutting System™ cutting mat (purchase at your local retailer). Remove the clear liner first, and apply to your cutting tray. Smooth any air bubbles out with your fingers, and apply firm pressure for good bond.
4. Remove the patterned liner or liner with Top Side label, to expose the tacky cutting surface.
5. Proceed with normal operation.

 **TIPS**

1. Store your Personal Cutting System™ in a secure location, such as the Personal Cutting System™ Carry Bag to reduce dust accumulation on the cutting mat.
2. Be sure that the new cutting mat is placed so that the patterned liner is facing up.
3. If your mat is still tacky, but the blade has cut all the way through, the mat needs to be replaced or blade damage could result.
4. Position the new cutting mat in the top left hand corner-see figure 3.2 – this will insure that your paper is properly backed during the cutting process.
5. Store unused cutting mats in a cool, dry place. This will protect their shelf life until ready for use.

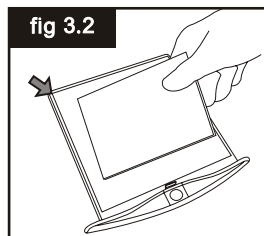

Selecting Shapes or Designs to Cut

1. Turn power on.
2. Open dock and insert any design book.
3. Load desired paper.
4. Open book, and select any shape by touching the highlighted button corresponding to designs within the book. Buttons appear as a solid or dashed circle. The machine will make an audible signal that a shape was selected.
5. Each shape has a number next to the button location on the Design Book. When pressed, this number will display on the LCD screen.
6. Press the Cut button

TIPS

1. *Select multiple shapes by pressing each shape once for each cut desired. Example, touch the same button twice for two cuts. Touch two different shapes to cut those shapes on the same paper currently inserted on the paper/cutting tray.*
2. *You may select as many shapes as desired – When there are no more cut locations on the paper, the Personal Cutting System™ will make an audible alert, and instruct you to start your cut. After the cut is complete, add more paper, and continue to select shapes.*

Resizing Shapes

Each shape in a Design Book is offered in three sizes. If a resize button is not selected, each shape will cut out in its pre-specified default size. The default size is determined by what is most usable for all Personal Cutting System™ owners.

You may resize any shape or font on the Personal Cutting System™.

A "+" before the number on the LCD indicates that you have selected to enlarge the shape.
A "-" before the number on the LCD indicates that you have selected to reduce the shape.



1. Before selecting a shape or design to cut, press the Enlarge or Reduce button. (fig. 6.1)  
2. Continue selecting shapes until ready to cut; press the Cut button.

fig 6.1



 **TIPS**

1. Select a resizing option before each shape selection.
2. You may select different sizes for different shapes during the same cutting session. You may continue to select until the machine fills up the paper with shapes to cut.
3. Resize different layers of layered designs to create custom shapes and layouts unique to you.

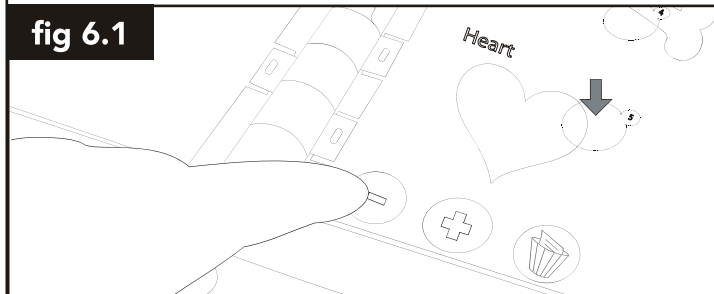
Deleting Selected Shapes

After each cut is performed, the Personal Cutting System™ automatically clears its memory, so that it can accept your next directions. You may find the need to delete a selection prior to the cut occurring.

1. After a shape is selected, and you decide to delete it, press the “trash can” icon on the design book. This feature acts as a backspace would on a computer – for each press of the icon, the last shape that was selected is deleted.
2. Select a new shape, or, press cut to start the machine on any shapes already selected.

 **TIPS**

1. If you want to delete the last shape chosen, use the "trash can" icon on the design book.
2. If you want to delete all shapes selected, press the red "cancel" button to the left of the LCD screen.

General Maintenance

Your Xyron Personal Cutting System™ is designed to be a long-lasting, durable machine. It is meant to be handled frequently, and includes safety features to keep all users protected, at all times. In order to function properly, the following safety features must be engaged.

Top Lid

The top lid must be closed for the Personal Cutting System™ to operate. If opened during operation, all cutting is immediately stopped. To return to its home position, close the lid, turn machine off then on.

 **TIPS** _____

1. Open the top lid if you need to manually clear material of the cutting surface, or to clean the machine.
2. The top lid is designed to snap off the machine if too much force is applied to during handling. The top lid simply snaps into place at the back hinge to the machine. No tools are required.

Paper/Cutting Tray

 **TIPS** _____

1. To remove the tray, press the button on the tray lip and pull out of the machine.
2. Inserting the tray. The tray will lock the tray into place for cutting.

When to Replace the Blade

The cutting blade needs to be replaced when it no longer easily cuts paper. Symptoms of a dull blade are:

- o Blade does not cut through entire shape.
- o Blade does not penetrate through paper in some areas of the shape.
- o Shape has noticeable paper fibers on edges, or, rough on edges.

Blades dull different for each user, based on several variables. While the Personal Cutting System™ will cut paper stocks up to 80#'s, or .010" thick doing so on a regular basis will dull the blade faster than if cutting vellums or thin scrapbook papers.

Safely discard dull blades by dropping them in an empty aluminum soda can, or plastic water bottle. This will insure that the blade is not handled directly by others after it has been thrown away.

WARNING: The blade has a safety guard that protects you from cutting yourself while handling. Putting excessive force on the protective blade cap could cause the blade cap to retract and expose the tip of the blade. For your safety, do not intentionally force this cap open when handling the blade.

Technical Specifications

Drive method	stepper motors
Maximum cutting area	3.85" x 3.85"
Cutting force	1.8 kg min.
Minimum character size	Depends on Design Book
Loadable number of tools	1
Blade types	45 degree
LCD size	2.5" x 5/8" (63.5mm x 15.87mm)
Power consumption	AC 100-240V 50/60Hz 1.2A dedicated power adapter
Rated power supply	16V DC 2.3 Amp
Operating environment	25°C
External dimensions	11in x 8.5in x 5.5in
Weight	Approximately 5 lbs (2.2 kg)
Maximum Paper thickness	Vellum to 80# cardstock .010" (.3mm)
Manufactured in	China

Trouble Shooting Guide

Symptom:	Issue:	Try This to Fix:
Unit does not turn on.	<ul style="list-style-type: none">• Unit not receiving power• Possible damage	<ul style="list-style-type: none">• Unplug power cable, plug back into socket.• Unplug power cable to unit, plug back into unit• Turn machine on and off• Contact Technical Support if unit does not function
Does Not Cut	<ul style="list-style-type: none">• Shape book not inserted into dock• Paper tray not locked into place• Top lid open	<ul style="list-style-type: none">• Open Top Lid, unscrew blade, push down on blade and hand tighten screw• Check for blade dullness – see maintenance section• Shapes may not yet be selected. Review LCD Screen to review selected shapes.

Trouble Shooting Guide

Symptom:	Issue:	Try This to Fix:
Does Not Cut	<ul style="list-style-type: none">• Shape book not inserted into dock• Paper tray not locked into place• Top lid open	<ul style="list-style-type: none">• Shape book may not be properly inserted. Remove book, check for any debris near where book spine contacts the dock. Reinsert book and select shapes• Shape book pages may not be flat on dock. Open book to selected page, and make sure pages, and binding of book lay flat on the dock.• Check that paper/cutting tray is fully engaged. Tray should be locked into position. Gently tug on tray to verify it is fully locked.• Check that top lid is shut.

Trouble Shooting Guide

Symptom:	Issue:	Try This to Fix:
Does Not Cut	<ul style="list-style-type: none">• Paper jammed in blade housing	<ul style="list-style-type: none">• Remove blade, and inspect the cutting edge. Do not retract the safety cover. If paper particles are exposed (jutting out from under the safety cover), use you shape removal tool to carefully remove the paper bits, and return the blade to the machine (see instructions of changing the blade).
Design Book does not insert easily into dock	<ul style="list-style-type: none">• Book inserted incorrectly• Dirt or refuse in canal where design book rests in dock	<ul style="list-style-type: none">• Book may be inserted upside down – remove and rotate, try to reinsert.• Check that no foreign debris has collected in the slot that the spine of the design book rests in the dock. The design book fits this canal perfectly, so, refuse may interfere with the book connection.

Trouble Shooting Guide

Symptom:	Issue:	Try This to Fix:
Blade has stopped in cutting area	<ul style="list-style-type: none">• Power was interrupted• Blade is jammed• Paper has come off cutting mat• Motor is damaged	<ul style="list-style-type: none">• Check to see if power cord is connected to power electrical outlet, and is firmly inserted into machine• Turn unit off, then on again – blade should return to home position• If you hear the motor running, but the blade is not moving, your blade may be jammed – turn machine off, open lid and remove paper, close lid and turn on. Blade should return to home position.• Turn machine off, open lid, remove paper. Remove paper/cutting tray by sliding out of machine. Turn machine on. Blade should return to home position.• If blade does still does not move to home position, you may have a damaged motor. Contact Xyron Tech Support at : 1-877-392-9474

Trouble Shooting Guide

Symptom:	Issue:	Try This to Fix:
Lid has detached from machine	<ul style="list-style-type: none">• Too much pressure applied to the lid, while opened, or, dropped	<ul style="list-style-type: none">• The lid breaks away when too much force is applied to it. To fix, simply snap back the hinge into the channel of the lid. The lid will function normally when reinserted.

If you are unable to isolate and solve your problem with the tips above, call Xyron Technical Support, at
1-877-392-9474